



NUCLEAR

High safety handling equipment and services

Independent
company since
1946

2400
People **around**
the world

More than
450
million Euros

5
Manufacturing
sites **worldwide**

**LONG-TERM
VISION** for the
sustainability
of **RESOURCES,
MEANS AND
QUALITY.**

REEL is a global leader in delivering complex and robust lifting and handling equipment to industries where safety and reliability are major challenges.

As an integrated engineering company, we design, manufacture, commission and maintain high-performance solutions adapted to ever evolving markets and customer requirements.

Our 75-year track record of excellence and 2400 dedicated employees make us the partner of choice in energy, aerospace, defense, metallurgy and environment industries.

We work closely with clients to improve their production processes, providing solutions that are integrated, sustainable and optimized, both technically and economically.

Our nuclear business

50 years experience in the design, manufacturing and maintenance of equipment for nuclear power plants.

REEL is present at all key stages of the fuel cycle with more than 1000 professionals involved in nuclear industry providing equipment and services to operators on a global scale.

Over the past seven decades,

We have built a reputation as a trusted partner. A flawless commitment to our values and to your success lies at the heart of this reputation. So does our determination to foster a zero harm culture that ensures the health and safety of your employees and ours.

Safety is both an absolute priority and a shared culture at REEL. Optimal performance requires complete safety. At REEL, they go hand in hand. This is our conviction.

A dedicated safety team oversees every activity on your site. 50 coaches are constantly rolling out a safety culture programme in the field towards 600 managers and their teams.

REEL International Quality Policy is based upon four principal

- Strive for customer satisfaction, through the comprehensive understanding of their real needs, and the provision of adapted solutions ;
- Ensure, at all times, the quality of our equipment and services ;
Make sure that the skills of our employees are fully in line with the
- company's needs ;
Perform all work while preserving the health and ensuring the safety

Our Quality Management System is regularly assessed by our clients during audits carried out on our various sites. The robustness of our quality management system is recognized through the specific qualifications delivered by key customers and national and international certificates: ISO9001, KTA1401, MASE, ... We are preparing our application to the new ISO19443.

SAFETY & QUALITY VALUES

A trusted
partner

ITER: double overhead
cranes 1500t capacity



The moment you partner with us,

We get into high gear. And you get a highly knowledgeable partner fully committed to ensure your success. Our goal is always to exceed your expectations.

From the initial concept to project execution and comprehensive after-sales services, each REEL employee assigned to your project is focused on delivering excellence, on time and within budget, while fostering a zero harm culture.

Our teams can rely on an extensive return on experience from our manufacturing and maintenance activities.

We manufacture our nuclear equipment in our own facilities.

Manufacturing is a key component of our identity and an unrivaled way to master quality and performance of our products.

Thus we can propose our customers solutions optimized to their needs and taking into account maintainability requirements from the design phase.

Dedicated project management teams build on industry best practices to minimize your operation and maintenance costs as well as optimize your lifecycle management. We leverage also the latest technologies for a higher level of efficiency and productivity.

COMMITTED TO YOUR SUCCESS

at each step
of the project

EPR Flamanville
refueling machine



THIS IS OUR COMMITMENT TO YOU

**FUEL HANDLING SYSTEMS &
EQUIPMENT SUPPLIED FOR THE NPP**



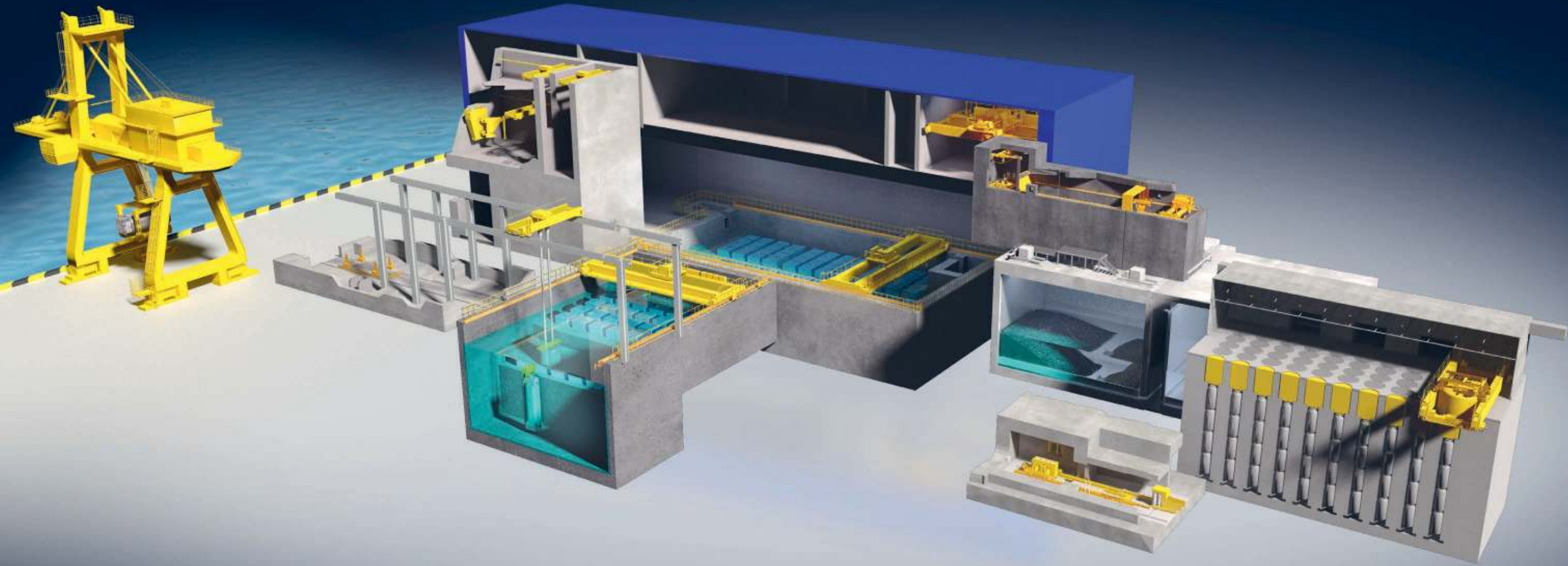

EQUIPMENT SUPPLIED TO THE
BACK-END FUEL CYCLE



- Equipment closely linked to the operability and availability of reactors ;
- Maintenance, modernization and spare parts ;
- Monitoring operations throughout the service life of each reactor.

**MORE THAN 50
YEARS EXPERIENCE**
IN THE DELIVERY
OF EQUIPMENT AND
OPERATION FOR
NUCLEAR PLANTS

Supply of critical
handling, lifting and
storage equipment
for nuclear reactors.



Refueling machine
▪
Spent fuel bridge
▪
Gantry crane
▪
Fuel elevator
▪
Transfer device
▪
Auxiliary cranes
▪
Reactor building crane
▪
Reactor Building Containment
▪
MSTM : Multi-Stud-Tensioning-Machine

**FUEL HANDLING
EQUIPMENT AND
INTEGRATED
SYSTEMS FOR SAFE,
EFFICIENT LOADING
AND UNLOADING
OPERATIONS**

Control the Complete Building
Reactor third protective barrier

**REACTOR
BUILDING STEEL
LINER STUDIES**

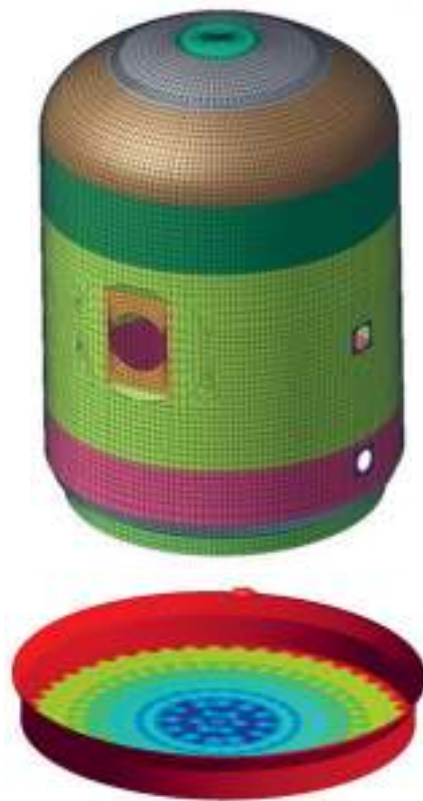

**Hatch and Personal Airlocks | EPR Design
High safety requirements**



**PERSONNAL
AIRLOCKS**



HATCH

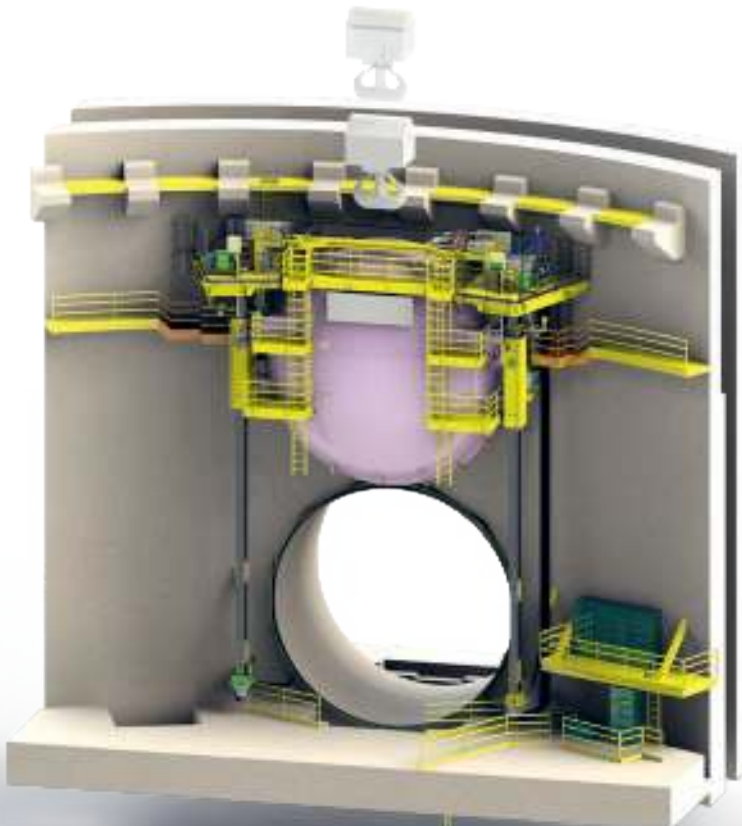

Nuclear island components

Equipment with the highest safety and reliability standards

- CRGT Columns
- Pool lighting
- Video
- RPV internal rig
- Sipping test machine
- Fuel examination handling tools

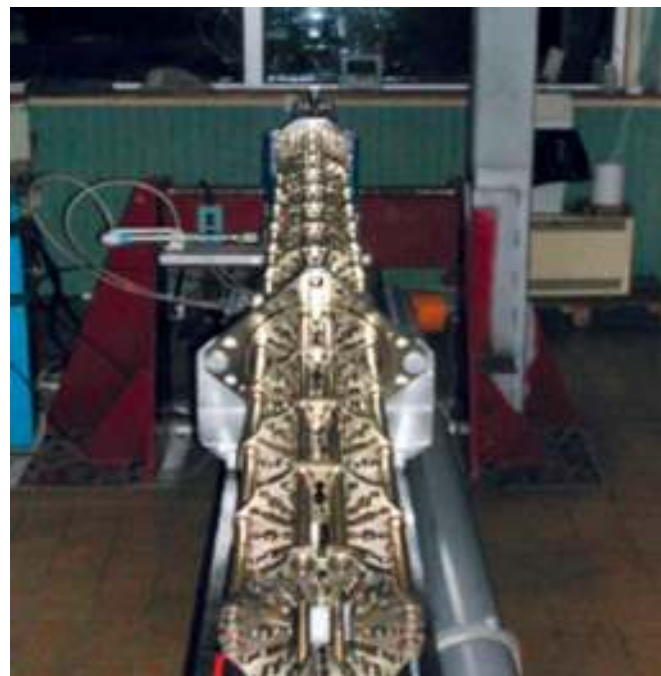
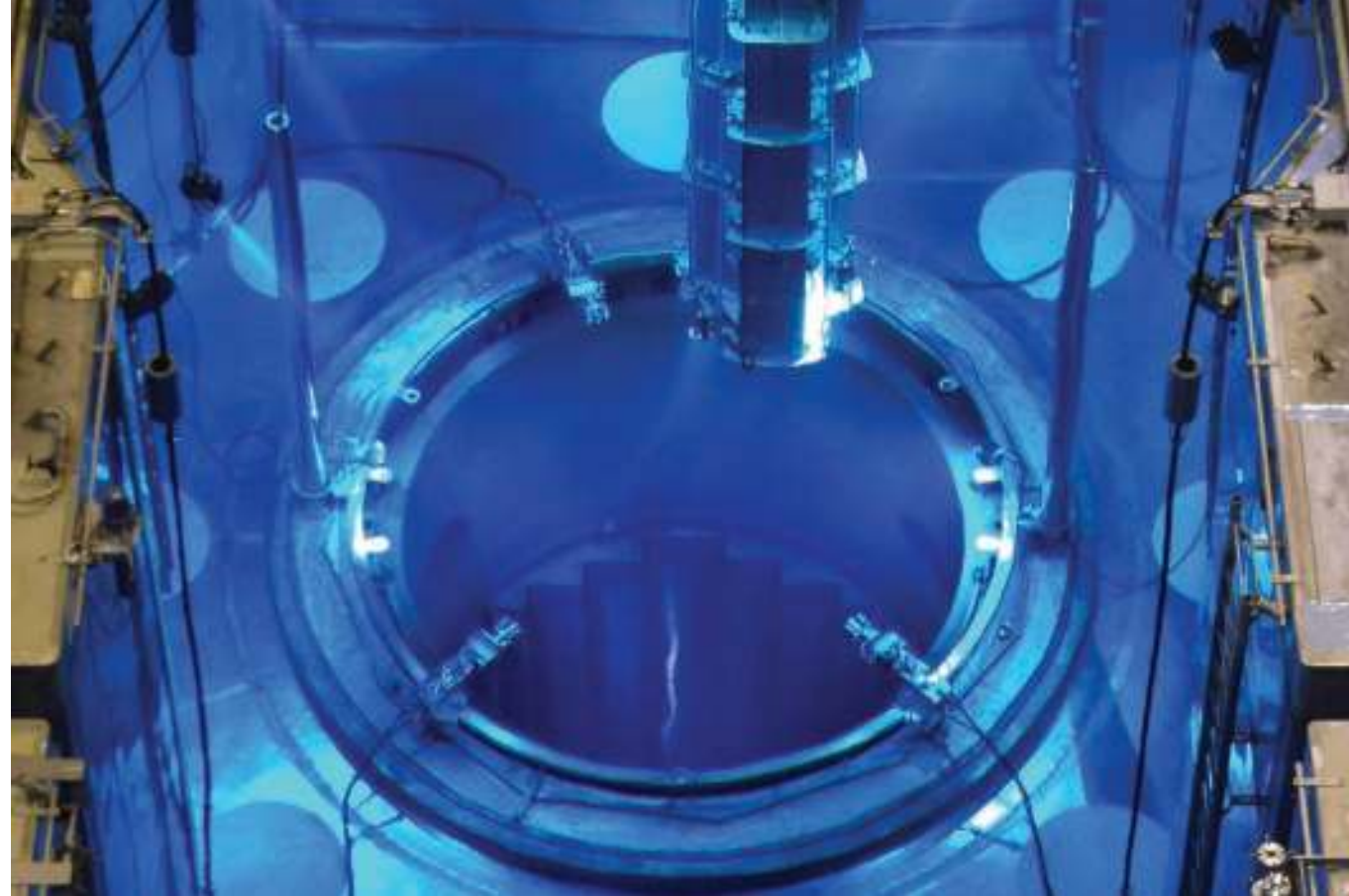

High density fuel assembly storage solutions

Compatibility with irradiated environments



Reracking operation



MORE THAN 18000 STORAGE CELLS FOR NEW NPP'S AND RERACKING OPERATIONS



Cold water intake
equipment

Filtration systems

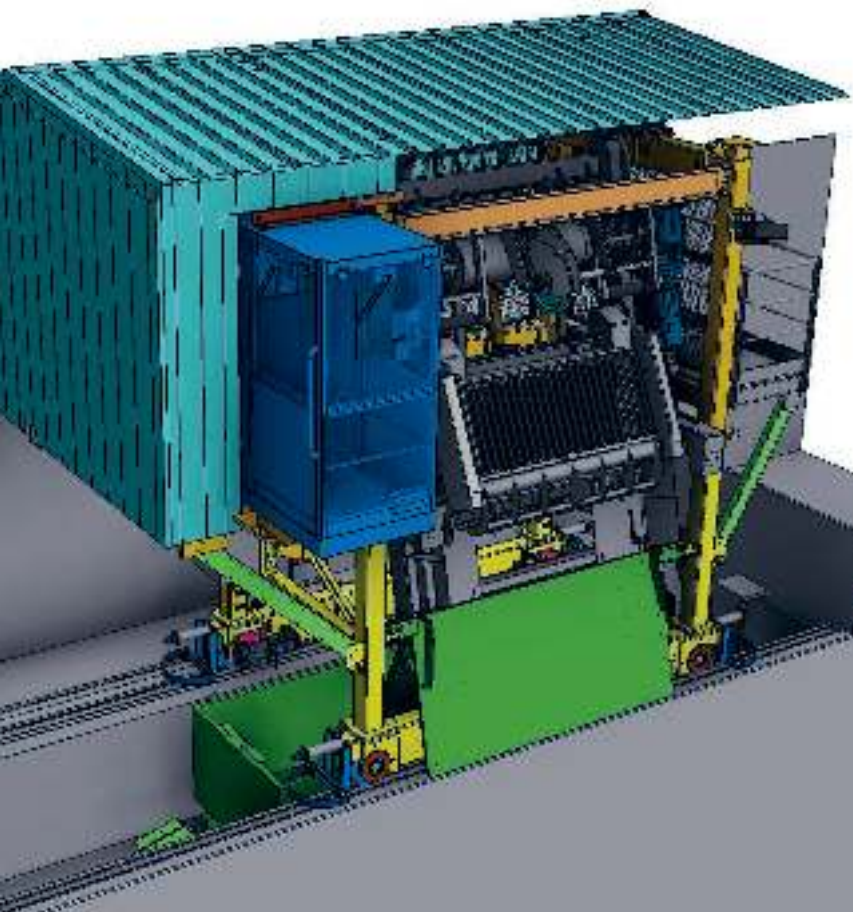

Process
equipment

For nuclear cycle facilities



Hot cell handling equipment

Remote handling systems for hot cells

- High safety hoisting cranes

- High activity waste container

Operating in highly irradiated areas for existing or new facilities:

- Reprocessing plant
- Enrichment plant
- Fuel fabrication
- Waste treatment facilities
- Dismantling operations

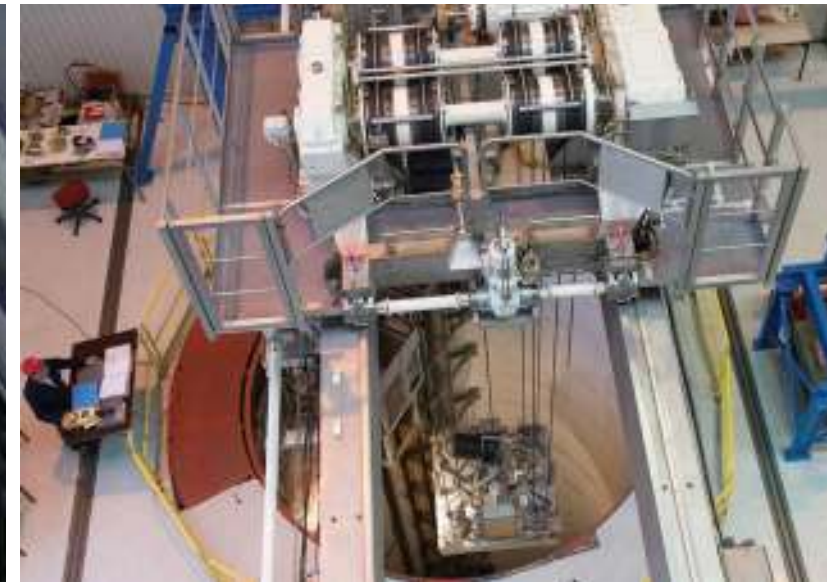

Maintenance engineering service

**“ REEL – MANUFACTURING &
MAINTENANCE – MORE THAN 50 YEARS’
EXPERIENCE IN MAINTENANCE ”**

- **Skills and professional attitude** of our personnel, trained by our inhouse **“REEL Academy”** ;
- Risk management culture ;
- Responsiveness, proximity (network of local agencies), availability ;
- Quick implementation of integrated technical solutions by our dedicated design offices and intervention teams ;
- Efficient management of spare parts, standardization and management of obsolescence in the long term.

- Preventive, predictive and corrective maintenance ;
- Improvement work, modernization and upgrading ;
- Installation and commissioning ;
- Risk analysis ;
- Nuclear safety studies ;
- Feasibility studies ;
- Technical support to operators ;
- Supervision services ;
- Maintenance methods and computer aided maintenance management ;
- Training ;
- Technological monitoring ;
- Spare parts and obsolescence management.



**600 technicians working at nuclear
site, of which 300 certified to
operate in nuclear reactors**

▪

40 reactors outages per year





REEL SAS

📍 69 Rue de la Chaux,
69450 Saint-Cyr au-Mont d'Or,
FRANCE
✉ commercial@reel.fr
☎ T: +33 4 72 29 76 00
☎ F: +33 4 78 64 83 92

www.reelinternational.fr



NFM Systems

📍 69 Rue de la Chaux,
69450 Saint-Cyr au-Mont d'Or,
FRANCE
☎ T: +33 4 87 25 44 28



REEL GmbH NKM Noell Special Cranes™

📍 Rudolf-Diesel-Strasse 1,
97209 Veitshoechheim, GERMANY
☎ T: +49 931 40473 0
☎ F: +49 931 40473 1000



REEL COH Inc.

📍 801 du Curé Boivin Blvd,
Boisbriand, Quebec,
CANADA, J7G 2J2
☎ T: +1 450 430-6500

www.reel-coh.com



AEMCO Vallée du Rhône – SIEGE

📍 2 rue Frédéric Mistral
30 200 CODOLET
☎ T: +33 4 66 50 93 04

www.aemco.reel.fr